

Programming Key Fobs

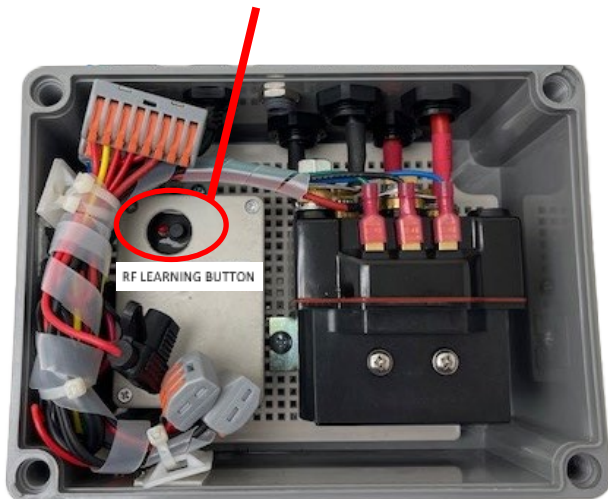

To sync replacement key fobs to your system, follow below steps.

1. Remove the top of your Wireless Control Box by loosening the 4 screws on top of the box.
2. Locate the “RF Learning Button” area.
3. Use your finger or a pencil to push the button in for three seconds then release.



Wireless Control Box



Wireless Key Fobs

4. Click any button on the Wireless Key Fob. A flashing red light next to the RF Learning Button will display once fob has been re-synced.